

09/08/99

CONTRACT NO.: DA00205 WBS ELEMENT: ICR.10281.27, ETC.

STATE OF NORTH CAROLINA
DIVISION OF HIGHWAYS

DARE COUNTY

STATE	STATE PROJECT REFERENCE NO.	SHEET NO.
N.C.	ICR.10281.27, ETC.	1
STATE PROJ. NO.	F.A. PROJ. NO.	DESCRIPTION
1C.10281.27		MAP 1

LOCATION: MAP 1 NC 12 FROM OLD LANDING RD. TO CHANGE OF PAVEMENT

TYPE OF WORK: MILLING & RESURFACING

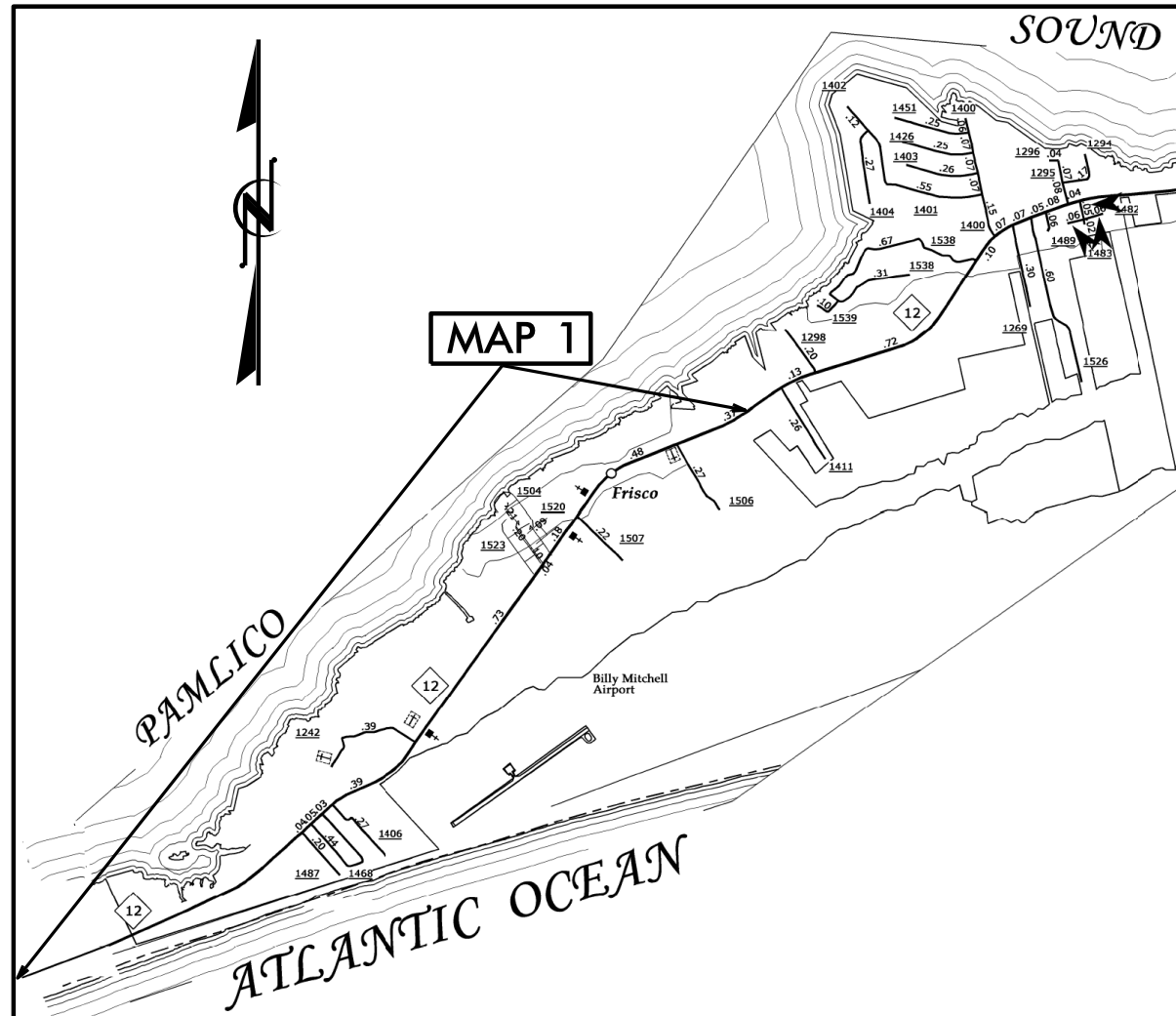

DRAWN BY: BWB

NTS

PROJECT LENGTH

LENGTH OF ROADWAY PROJECT MAP 1 = 4.36 MI.

Prepared in the Office of:
DIVISION OF HIGHWAYS
113 Airport Dr., Edenton NC, 27932

2012 STANDARD SPECIFICATIONS

LETTING DATE:

W.B. HOBBS, P.E.
DIVISION PROJECT MANAGER

C.E. SLACHTA
DIVISION PROPOSALS ENGINEER

DIVISION OF HIGHWAYS
STATE OF NORTH CAROLINA

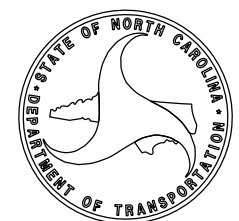

09/08/99

CONTRACT NO.: DA00205 WBS ELEMENT: ICR.10281.27, ETC.

STATE OF NORTH CAROLINA
DIVISION OF HIGHWAYS

DARE COUNTY

STATE	STATE PROJECT REFERENCE NO.	SHEET NO.
N.C.	ICR.10281.27, ETC.	2
STATE PROJ. NO.	F.A. PROJ. NO.	DESCRIPTION
1CR.10281.28		MAP 2
1CR.20281.103		MAP 3
1CR.20281.104		MAP 4
1CR.20281.105		MAP 5
1CR.20281.106		MAP 6
1CR.20281.107		MAP 7

TYPE OF WORK: MILLING & RESURFACING

LOCATION:

MAP 2 NC 345 FROM US 64 TO SR 1168

MAP 3 SR 1142 DANIELS RD. FROM NC 345 TO SR 1143

MAP 4 SR 1139 JOVERS LN. FROM NC 345 TO END OF MAINTENANCE

MAP 5 SR 1137 OWENS SHIPYARD RD. FROM SR 1168 TO SR 1168

MAP 6 SR 1140 HARBOR RD./WANCHESE SEAFOOD IND PARK FROM NC 345 TO CHANGE OF PAVEMENT

MAP 7 SR 1138 TILLET RD. FROM NC 345 TO DEAD END

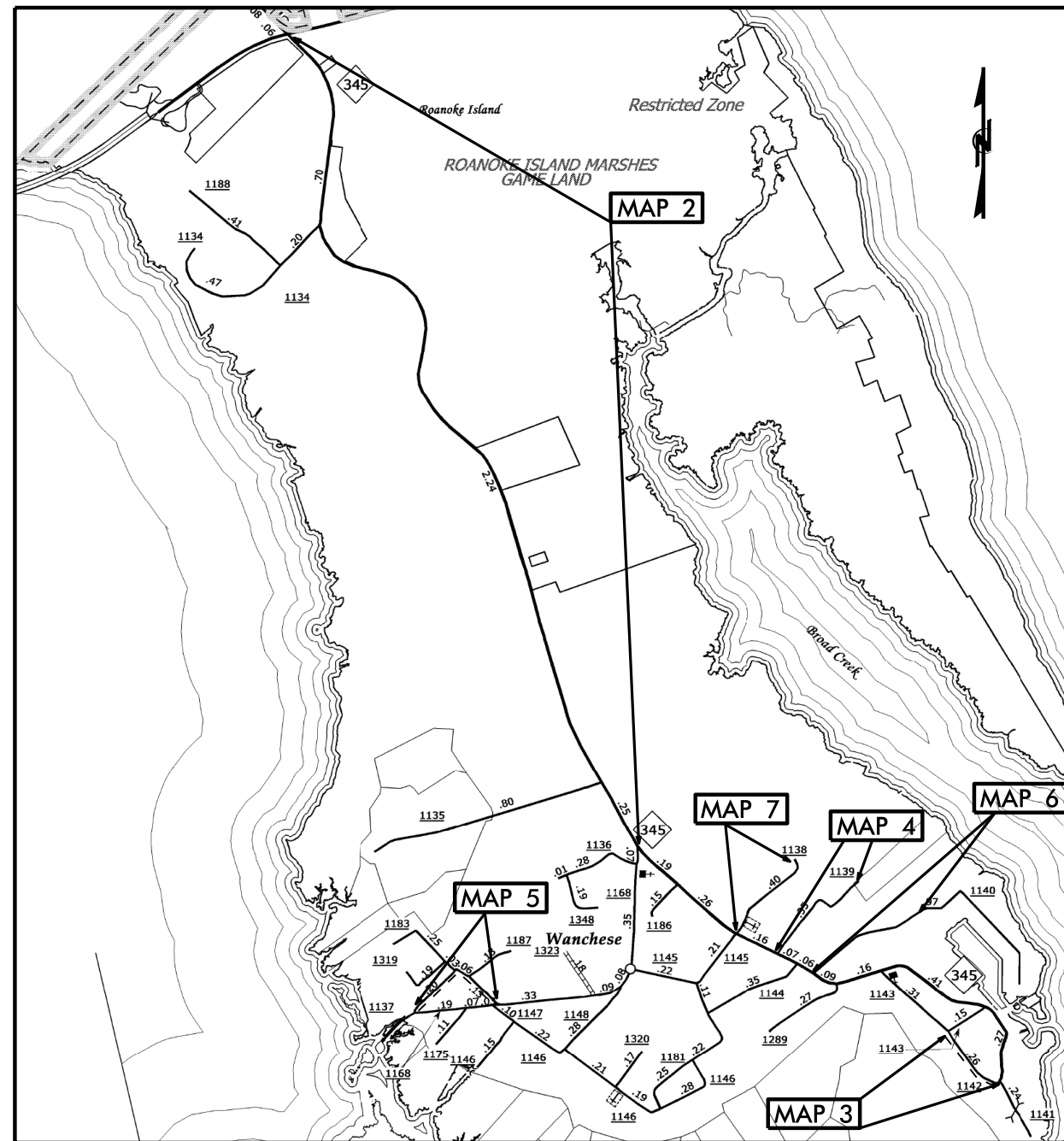

NTS

PROJECT LENGTH

- LENGTH OF ROADWAY PROJECT MAP 2 = 3.19 MI.
- LENGTH OF ROADWAY PROJECT MAP 3 = 0.26 MI.
- LENGTH OF ROADWAY PROJECT MAP 4 = 0.34 MI.
- LENGTH OF ROADWAY PROJECT MAP 5 = 0.36 MI.
- LENGTH OF ROADWAY PROJECT MAP 6 = 0.43 MI.
- LENGTH OF ROADWAY PROJECT MAP 7 = 0.30 MI.

Prepared in the Office of:
DIVISION OF HIGHWAYS
113 Airport Dr., Edenton NC, 27932

2012 STANDARD SPECIFICATIONS

LETTING DATE:

W.B. HOBBS, P.E.
DIVISION PROJECT MANAGER

C.E. SLACHTA
DIVISION PROPOSALS ENGINEER

**DIVISION OF HIGHWAYS
STATE OF NORTH CAROLINA**

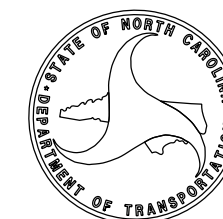

DRAWN BY: BMB

09/08/99

CONTRACT NO.: DA00205 WBS ELEMENT: ICR.10281.27, ETC.

STATE OF NORTH CAROLINA
DIVISION OF HIGHWAYS
DARE COUNTY

STATE	STATE PROJECT REFERENCE NO.	SHEET NO.
N.C.	ICR.10281.27,ETC.	3
STATE PROJ.NO.	F.A.PROJ.NO.	DESCRIPTION
1CR.10281.108		MAP 8
1CR.10281.109		MAP 9
1CR.10281.110		MAP 10
1CR.10281.111		MAP 11
1CR.10281.112		MAP 12
1CR.10281.113		MAP 13
1CR.10281.114		MAP 14
1CR.10281.115		MAP 15
1CR.10281.116		MAP 16
1CR.10281.117		MAP 17

TYPE OF WORK: MILLING & RESURFACING

LOCATION:

- MAP 8 SR 1189 SIR WALTER RALEIGH ST.FROM US 64 TO NC 400
- MAP 9 SR 1330 BARTOW DR.FROM SR 1123 TO CUL-DE-SAC
- MAP 10 SR 1305 RIMPAUL RD.FROM SR 1123 TO SR 1344
- MAP 11 SR 1344 TIMBERLIN WAY FROM CUL-DE-SAC TO DEAD END
- MAP 12 SR 1174 GASTON AVE./BARLOWE FROM US 64 TO SR 1121
- MAP 13 SR 1120 MOTHERS VINEYARD RD.FROM US 64 TO SR 1347
- MAP 14 SR 1173 SECOND ST./JACKSON ST.FROM SR 1118 TO SR 1157
- MAP 15 SR 1173 SECOND ST.FROM SR 1157 TO DEAD END
- MAP 16 SR 1172 FIRST ST.FROM SR 1118 TO SR 1157
- MAP 17 SR 1172 FIRST ST.FROM SR 1157 TO DEAD END

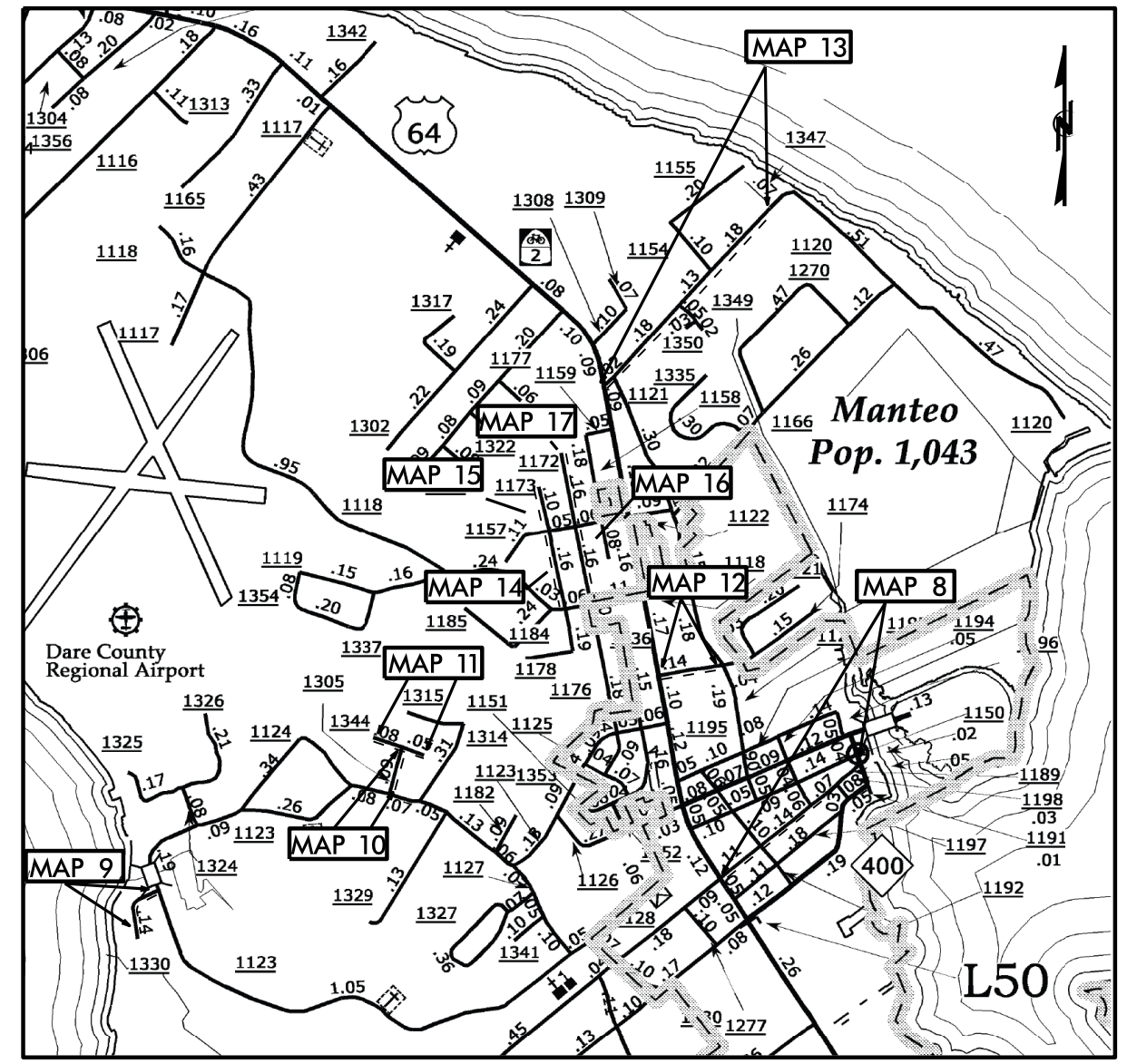

NTS

PROJECT LENGTH

LENGTH OF ROADWAY PROJECT	MAP 8 = 0.36 MI.
LENGTH OF ROADWAY PROJECT	MAP 9 = 0.15 MI.
LENGTH OF ROADWAY PROJECT	MAP 10 = 0.09 MI.
LENGTH OF ROADWAY PROJECT	MAP 11 = 0.14 MI.
LENGTH OF ROADWAY PROJECT	MAP 12 = 0.13 MI.
LENGTH OF ROADWAY PROJECT	MAP 13 = 0.50 MI.
LENGTH OF ROADWAY PROJECT	MAP 14 = 0.16 MI.
LENGTH OF ROADWAY PROJECT	MAP 15 = 0.09 MI.
LENGTH OF ROADWAY PROJECT	MAP 16 = 0.16 MI.
LENGTH OF ROADWAY PROJECT	MAP 17 = 0.16 MI.

Prepared in the Office of:
DIVISION OF HIGHWAYS
113 Airport Dr., Edenton NC, 27932

2012 STANDARD SPECIFICATIONS

LETTING DATE:

W.B. HOBBS, P.E.
DIVISION PROJECT MANAGER

C.E. SLACHTA
DIVISION PROPOSALS ENGINEER

DIVISION OF HIGHWAYS
STATE OF NORTH CAROLINA

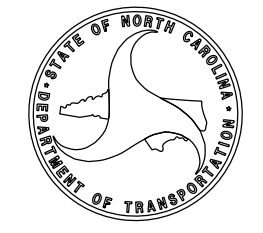

DRAWN BY: BWB

C O N T R A C T P A V E M E N T S C H E D U L E

C1	PROP. APPROX. 1½" ASPHALT CONCRETE SURFACE COURSE, TYPE SF9.5A, AT AN AVERAGE RATE OF 165 LBS. PER SQ. YD.
C2	PROP. APPROX. 1½" ASPHALT CONCRETE SURFACE COURSE, TYPE S9.5B, AT AN AVERAGE RATE OF 168 LBS. PER SQ. YD.
T	EARTH MATERIAL
U	EXISTING PAVEMENT
V1	MILLING BITUMINOUS PAVEMENT. 1½" DEPTH

PAVEMENT SCHEDULE

C1	PROP. APPROX. 1½" ASPHALT CONCRETE SURFACE COURSE, TYPE SF9.5A, AT AN AVERAGE RATE OF 165 LBS. PER SQ. YD.
U	EXISTING PAVEMENT.
T	EARTH MATERIAL

PROJECT REFERENCE NO.	SHEET NO.
1CR.10281.27, ETC.	5

NOTES:

*ALL PAVED S.R. ROADS TO BE RESURFACED TO THE ENDS OF THE RADII, OR AS DIRECTED BY THE ENGINEER

*EDGES, PAVEMENT WIDENING, INTERSECTIONS, AND BRIDGE FLARES ARE INCLUDED IN THE TABLE OF QUANTITIES

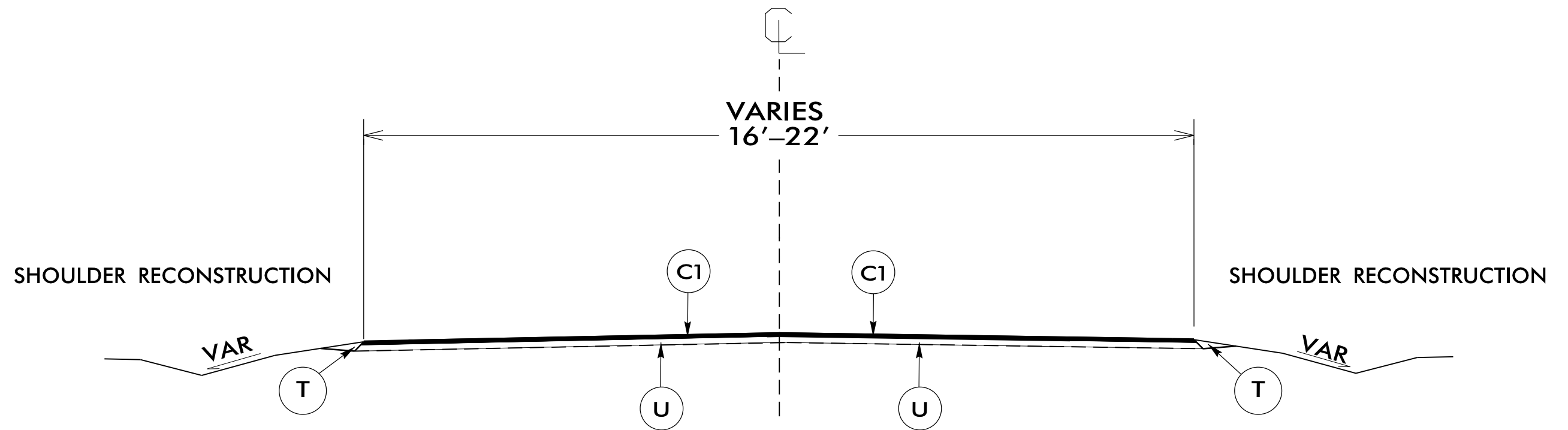

TYPICAL SECTION NO. 1

USE WITH MAP 3-5, 7, 9-17

NTS

P A V E M E N T S C H E D U L E

C1	PROP. APPROX. 1½" ASPHALT CONCRETE SURFACE COURSE, TYPE SF9.5A, AT AN AVERAGE RATE OF 165 LBS. PER SQ. YD.
U	EXISTING PAVEMENT.
V1	MILLING BITUMINOUS PAVEMENT. 1½" DEPTH.

PROJECT REFERENCE NO.	SHEET NO.
1CR.10281.27, ETC.	6

NOTES:

*ALL PAVED S.R. ROADS TO BE RESURFACED TO THE ENDS OF THE RADII, OR AS DIRECTED BY THE ENGINEER

*EDGES, PAVEMENT WIDENING, INTERSECTIONS, AND BRIDGE FLARES ARE INCLUDED IN THE TABLE OF QUANTITIES

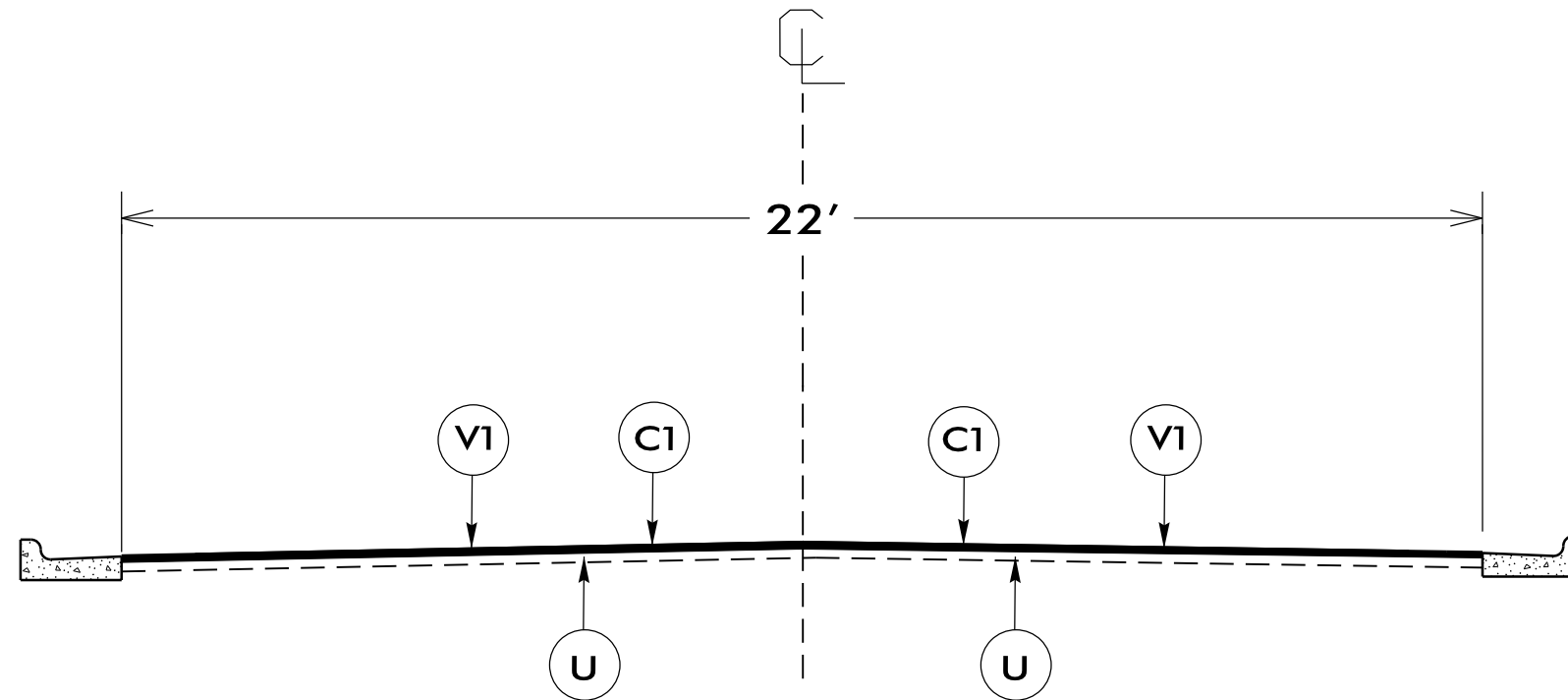

TYPICAL SECTION NO. 2

USE WITH MAP 8

NTS

PAVEMENT SCHEDULE

C2	PROP. APPROX. 1½" ASPHALT CONCRETE SURFACE COURSE, TYPE S9.5B, AT AN AVERAGE RATE OF 168 LBS. PER SQ. YD.
U	EXISTING PAVEMENT.
T	EARTH MATERIAL

PROJECT REFERENCE NO.	SHEET NO.
1CR.10281.27, ETC.	7

NOTES:

*ALL PAVED S.R. ROADS TO BE RESURFACED TO THE ENDS OF THE RADII, OR AS DIRECTED BY THE ENGINEER

*EDGES, PAVEMENT WIDENING, INTERSECTIONS, AND BRIDGE FLARES ARE INCLUDED IN THE TABLE OF QUANTITIES

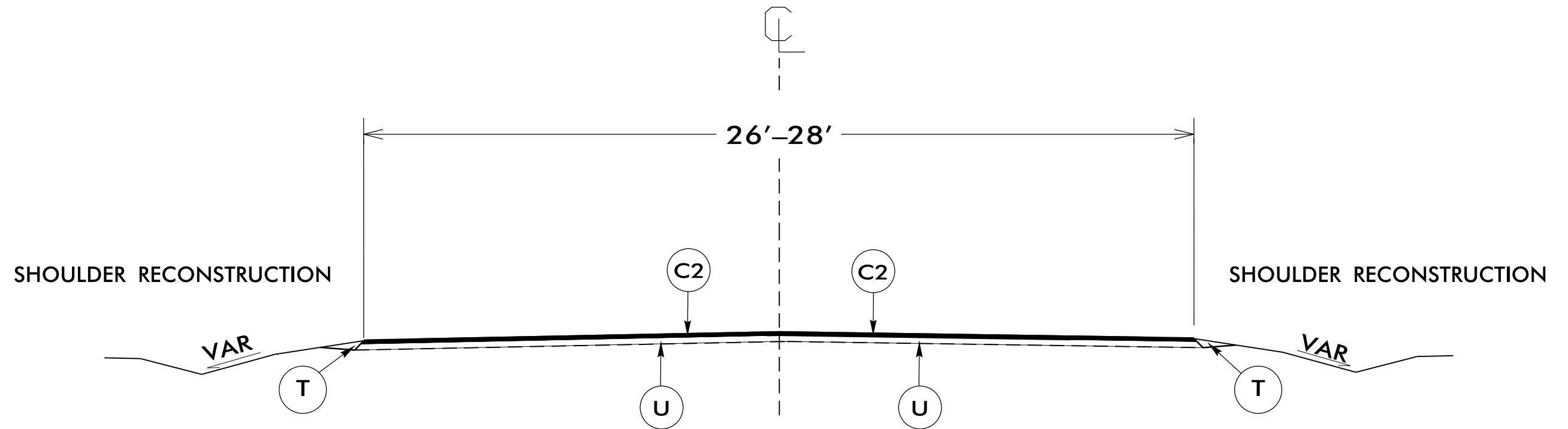

TYPICAL SECTION NO. 3

USE WITH MAP 2 , 6

NTS

P A V E M E N T S C H E D U L E

C2	PROP. APPROX. 1½" ASPHALT CONCRETE SURFACE COURSE, TYPE S9.5B, AT AN AVERAGE RATE OF 168 LBS. PER SQ. YD.
T	EARTH MATERIAL
U	EXISTING PAVEMENT.
V1	MILLING BITUMINOUS PAVEMENT. 1½" DEPTH.

PROJECT REFERENCE NO.	SHEET NO.
1CR.10281.27, ETC.	8

NOTES:

*ALL PAVED S.R. ROADS TO BE RESURFACED TO THE ENDS OF THE RADII, OR AS DIRECTED BY THE ENGINEER

*EDGES, PAVEMENT WIDENING, INTERSECTIONS, AND BRIDGE FLARES ARE INCLUDED IN THE TABLE OF QUANTITIES

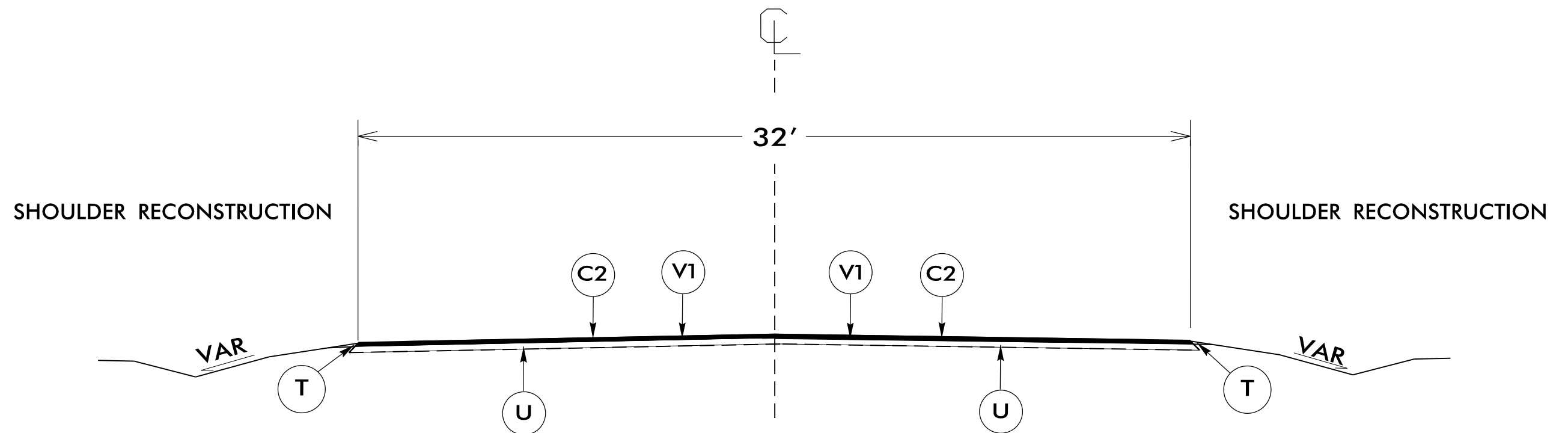

TYPICAL SECTION NO. 4

USE WITH MAP 1

NTS

PROJECT NO.	SHEET NO.	TOTAL NO.
1CR.10281.27, ETC.	9	9

SUMMARY OF QUANTITIES

PROJECT NO	COUNTY	MAP NO	ROUTE	DESCRIPTION	TYP NO	LANES	LANE TYPE	FINAL SURFACE TESTING REQUIRED	WARM MIX ASPHALT REQUIRED	LENGTH MI	WIDTH FT	MOBILIZATION LS	BORROW CY	INCIDENTAL STONE BASE TONS	SHOULDER RECONSTRUCTION SMI	1½" MILLING SY	INCIDENTAL MILLING SY	SURFACE COURSE, S9.5B TONS	SURFACE COURSE, SF9.5A TONS	ASPHALT BINDER FOR PLANT MIX TONS	MILLED RUMBLE STRIPS (ASPHALT CEMENT CONCRETE) LF	CONCRETE CURB RAMPS EA	ADJ. OF MANHOLES EA	ADJ. OF METER OR VALVE BOX EA	SEEDING & MULCHING ACR	TEMPORARY TRAFFIC CONTROL LS
1CR.10281.27	Dare	1	NC 12	FROM OLD LANDING ROAD SOUTH TO CHANGE OF PAVEMENT	4	2	2WU	NO	NO	4.36	32	1	1,700	15	8.72	85,000		8,033		482			4	5.30	1	
1CR.10281.28	Dare	2	NC 345	FROM US 64 TO SR 1168	3	2	2WU	NO	NO	3.19	26	*	2,000	20	6.38		30	4,518		271	31,300				5.40	*
1CR.20281.103	Dare	3	SR 1142 DANIELS ROAD	FROM NC 345 TO SR 1143	1	2	2WU	NO	NO	0.26	16	*	100	10	0.52				223	15					0.25	*
1CR.20281.104	Dare	4	SR 1139 JOVERS LANE	NC 345 TO END OF MAINTENANCE	1	2	2WU	NO	NO	0.34	16	*	200	10	0.68				279	19				2	0.40	*
1CR.20281.105	Dare	5	SR 1137 OWENS SHIPYARD ROAD	FROM SR 1168 TO SR 1168	1	2	2WU	NO	NO	0.36	20	*	100	15	0.72				386	26					0.79	*
1CR.20281.106	Dare	6	SR 1140 HARBOR ROAD OR WANCHESE SEAFOOD IND PARK	FROM NC 345 TO CHANGE of PAVEMENT	3	2	2WU	NO	NO	0.43	28	*	100	30	0.86		32	656		39					0.53	*
1CR.20281.107	Dare	7	SR 1138 TILLET RD	FROM NC 345 TO DEAD END	1	2		NO	NO	0.30	18	*	200	5	0.60				289	19					0.40	*
1CR.20281.108	Dare	8	SR 1189 SIR WALTER RALEIGH ST	FROM US 64 TO NC 400	2	2	2WU	NO	NO	0.36	22	*				5,250			589	39		18	9	7		*
1CR.20281.109	Dare	9	SR1330 BARTOW DR	SR 1123 TO CUL-DE-SAC	1	2	2WU	NO	NO	0.15	18	*	100	5	0.30				145	10					0.20	*
1CR.20281.110	Dare	10	SR 1305 RIMPAUL ROAD	FROM SR 1123 TO SR 1344	1	2	2WU	NO	NO	0.09	18	*		5	0.18				79	5					0.20	*
1CR.20281.111	Dare	11	SR 1344 TIMBERLIN WAY	FROM CUL-DE-SAC TO DEAD END	1	2	2WU	NO	NO	0.14	18	*	20	5	0.28				152	10					0.20	*
1CR.20281.112	Dare	12	SR 1174 GASTON AVE/BARLOWE	FROM US 64 END to SR 1121	1	2	2WU	NO	NO	0.13	20	*	50	5	0.26				125	8		1	1		0.15	*
1CR.20281.113	Dare	13	SR 1120 MOTHERS VINEYARD rd	FROM US 64 TO SR 1347	1	2	2WU	NO	NO	0.50	22	*	200	10	1.00				535	36				4	0.60	*
1CR.20281.114	Dare	14	SR 1173 SECOND ST/JACKSON ST	FROM SR 1118 TO SR 1157	1	2	2WU	NO	NO	0.16	20	*	100	15	0.32				156	10					0.19	*
1CR.20281.115	Dare	15	SR 1173 SECOND ST	FROM SR 1157 TO DEAD END	1	2	2WU	NO	NO	0.09	18	*	50	5	0.18				87	6				1	0.10	*
1CR.20281.116	Dare	16	SR 1172 FIRST ST	FROM SR 1118 TO SR 1157	1	2	2WU	NO	NO	0.16	20	*	100	5	0.32				171	11					0.20	*
1CR.20281.117	Dare	17	SR 1172 FIRST ST	FROM SR 1157 TO DEAD END	1	2	2WU	NO	NO	0.16	20	*	100	5	0.32				171	11					0.20	*
GRAND TOTAL										11.18		1	5,120	165	21.64	90,250	62	13,207	3,387	1,017	31,300	19	10	18	15.11	1

- NOTES:
- 1) DETAIL DOES NOT APPLY TO OGAFc AND ULTRA-THIN BONDED WEARING COURSE.
 - 2) BACKFILL SHOULDER WITH APPROVED MATERIAL.
 - 3) THE SHOULDER WEDGE DEVICE MAY BE DISENGAGED AT PAVED DRIVEWAYS AND SIDE STREETS.

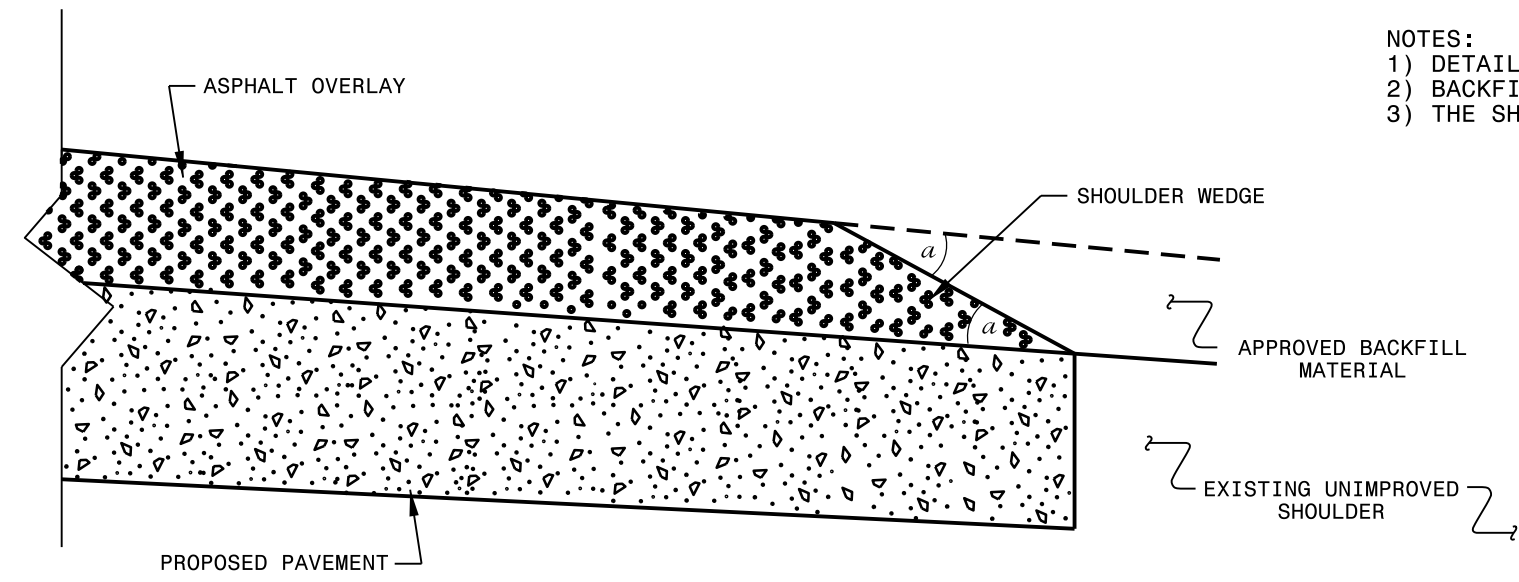

SHOULDER WEDGE DETAIL
 (Resurfacing Projects w/ Widening or
 with Existing Paved Shoulder having no dropoffs)

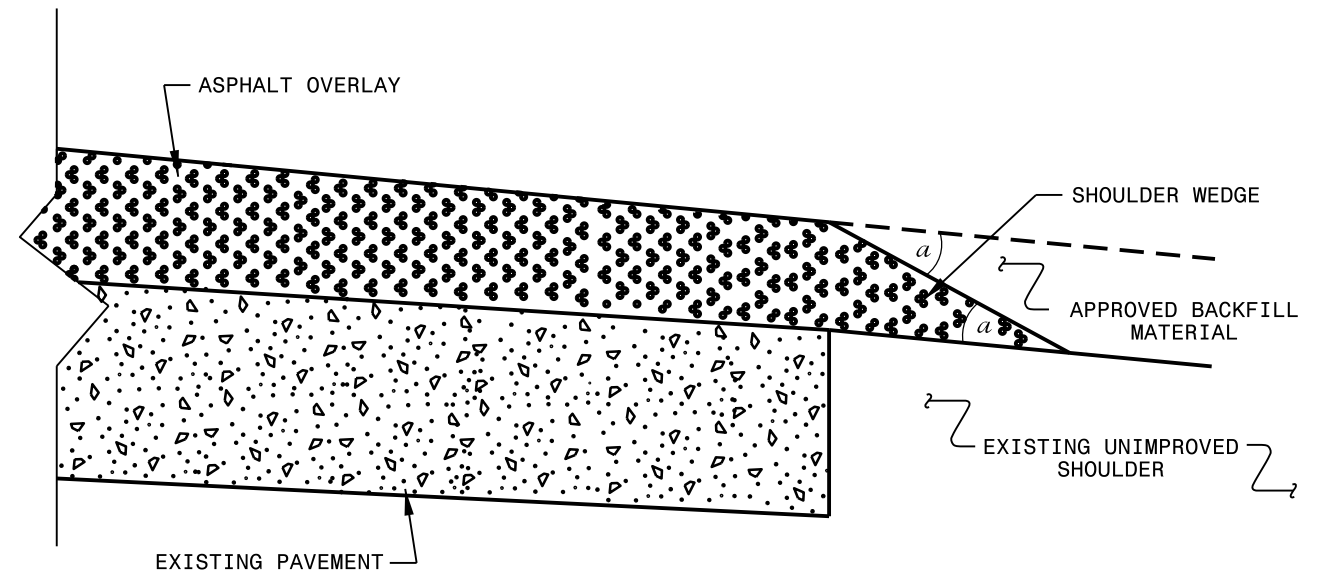

SHOULDER WEDGE DETAIL
 (Resurfacing Projects w/ NO Widening)

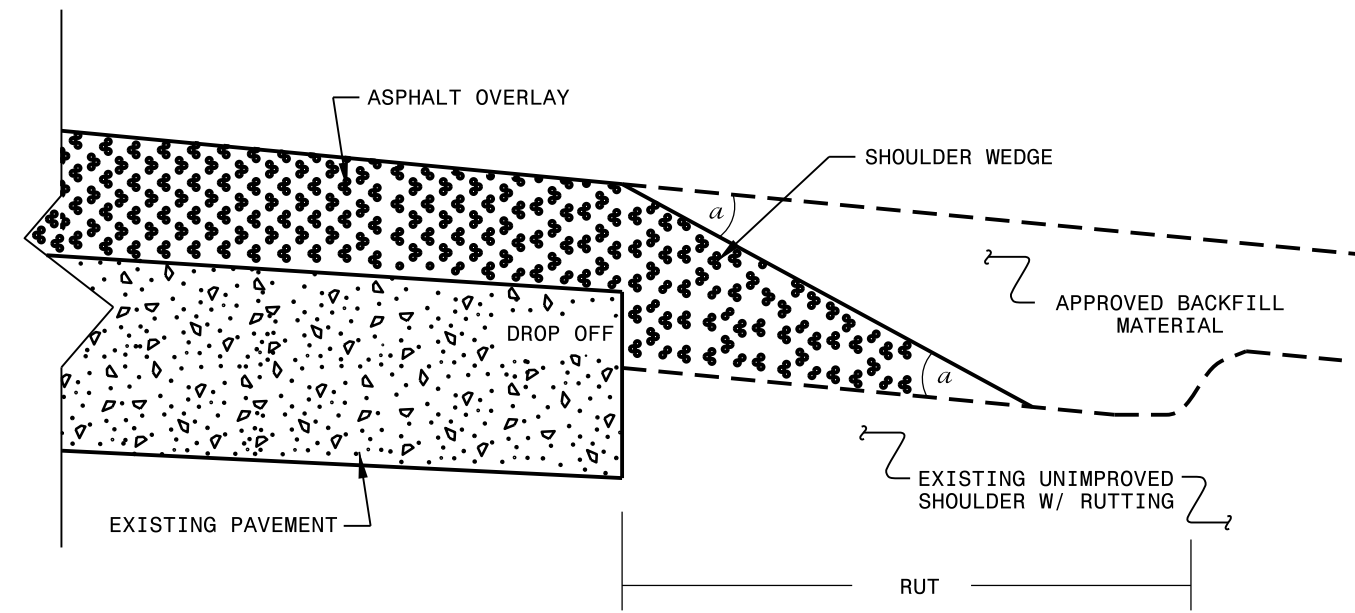

SHOULDER WEDGE DETAIL
 (Resurfacing Adjacent to
 Rutted Shoulder)

- SHOULDER WEDGE ANGLE = 30°

CONTRACT STANDARDS AND DEVELOPMENT UNIT			
Office 919-707-6950		FAX 919-250-4119	
SHOULDER WEDGE DETAILS			
ORIGINAL BY: T.SPELL	DATE: 7-19-11		
MODIFIED BY:	DATE: 10/16/12		
CHECKED BY:	DATE:		
FILE SPEC.: susr/details/stand/shoulderwedgedetail.dgn			

SYSTEM: 11/11/11
 USER: T.SPELL
 FILE: susr/details/stand/shoulderwedgedetail.dgn